



## CHEESEMAN'S ECOLOGY SAFARIS

2059 Camden Ave. #419  
San Jose, CA 95124 USA  
(800) 527-5330 (408) 741-5330  
info@cheesemans.com  
cheesemans.com

### Galápagos Islands

#### *Evolution's Playground*

May 7 to 25, 2022



Marine Iguana

© Cheesemans' Ecology Safaris

## SAFARI OVERVIEW

---

Sail on the most in-depth itinerary possible around this archipelago famous for charismatic wildlife unafraid of you or your camera. Explore Ecuador's lush cloud forest before embarking on the *Samba* for a 15-day voyage around the Enchanted Isles. With our expert resident leader, discover endemic reptiles, tropical land birds, breeding boobies, albatross, penguins, marine mammals, sharks, tropical fish, and much more! With early and late landings to coincide with peak wildlife action, this special expedition caters to photographers and wildlife enthusiasts alike. The evolutionary story of the Galápagos Islands has been told many times but only through immersing yourself in its splendor can you truly appreciate the impressive forces that shape nature here.

### HIGHLIGHTS

- Navigate among 16 islands and experience the diversity of the archipelago.
- Snorkel with sea lions, penguins, tropical fish, sharks, rays, and rare coral formations.
- View mating behavior of frigatebirds, blue-footed boobies, and waved albatross on Española Island – the only known waved albatross nesting site in the world.

- Visit the Charles Darwin Research Station and learn about conservation and restoration programs.
- Observe hummingbirds, Andean cock-of-the-rock, and other birds in Ecuador’s cloud forest.

**LEADER:** Juan Manuel Salcedo plus an assistant guide.

**DAYS:** 19, including estimated travel time. 14 nights aboard the *Samba*.

**GROUP SIZE:** 14.

**BOAT:** The *Samba*. See the *Boat* section on page 3.

**COST:** \$11,200 to \$12,300 per person depending on cabin type, double occupancy, not including airfare, singles extra. See the *Costs* section on page 8.

Date	Description (Island names are in bold)	Accommodation	Meals
May 7	Arrive in Quito, Ecuador.	Holiday Inn Quito Airport, Quito	—
May 8	Explore the cloud forest for bird watching in Yanacocha and Old Nono-Mindo. Observe Andean cock-of-the-rock lek. Watch nocturnal mammals near the lodge.	Bellavista Cloud Forest Lodge, Tandayapa	B, L, D
May 9	Watch for many dazzling species of birds. Visit Refugio Paz de las Aves. Possible stop at Mitad del Mundo.	Holiday Inn Quito Airport, Quito	B, L, D
May 10	Fly to <b>Baltra</b> and board the <i>Samba</i> . First landing on <b>Mosquera Islet</b> .	Aboard the <i>Samba</i>	B, L, D
May 11	<b>Genovesa:</b> Darwin Bay and Prince Philip’s Steps.		B, L, D
May 12	<b>Marchena:</b> Snorkel at Punta Mejía and Playa Negra.		B, L, D
May 13	<b>Isabela:</b> Punta Albemarle and Punta Vicente Roca.		B, L, D
May 14	<b>Fernandina:</b> Punta Espinoza. <b>Isabela:</b> Urbina Bay.		B, L, D
May 15	<b>Isabela:</b> Elizabeth Bay and Punta Moreno.		B, L, D
May 16	<b>Floreana:</b> Asilo de la Paz, Cerro Alieri, and Devil’s Crown.		B, L, D
May 17	<b>Santa Cruz:</b> Highlands and Charles Darwin Research Station.		B, L, D
May 18	<b>Floreana:</b> Punta Cormorant and Post Office Bay.		B, L, D
May 19	<b>Española:</b> Punta Suárez with waved albatross and Gardner Bay.		B, L, D
May 20	<b>San Cristóbal:</b> Punta Pitt and Isla Lobos.		B, L, D
May 21	<b>Santa Fé:</b> Barrington Bay. <b>South Plaza.</b>		B, L, D
May 22	<b>Sombrero Chino Islet. Bartolomé:</b> Pinnacle Rock.		B, L, D
May 23	<b>Santiago:</b> James Bay. <b>Rábida.</b>		B, L, D
May 24	Last landing at <b>North Seymour</b> , disembark at <b>Baltra</b> , and fly to Quito.	Holiday Inn Quito Airport, Quito	B
May 25	Fly home.		B

## LEADER

---



### **Juan Manuel Salcedo**

Juan grew up in the Galápagos Islands where he developed his passion for wildlife while sailing on his father's boat. He received a degree from the University of San Francisco, Quito after studying Applied Ecology, Biology and Geology. Juan also earned a skipper certificate after studying sailing and navigation in Los Angeles. Involvement in Environmental Education projects in the Galápagos Islands and on mainland Ecuador fills his spare time.

## BOAT

---

### **The Samba**

The *Samba* is a 78-ft, steel-hulled motor yacht with a stabilizing sail making her the perfect choice to experience the Galápagos Islands to their fullest. This sturdy, stately, and very comfortable ocean-going vessel is a European Dutch classic and best in her class with a specially designed high bow. The *Samba* accommodates 14 guests in seven air-conditioned double cabins with private bathrooms and hot water. The topside settees and ample forward deck provide getaways or extra space for group activities such as stargazing, whale watching, or sunbathing. The main salon and aft dining facilities make her very socially versatile. The local chef prepares excellent international cuisine with organically-grown, local produce and can accommodate most dietary requests with advance notice. The *Samba* is a graceful, top-quality, and fuel-efficient craft owned by the Salcedo family who employ Galápagos-resident crewmembers that take pride in sharing their love and dedication to these beautiful islands. The experienced and friendly crew is committed to redefining quality and excellence and takes great care in making everything environmentally friendly plus socially responsible. See the *Deck Plan* on page 12.



## DETAILED ITINERARY

---

### **May 7 ~ Arrive in Quito, Ecuador**

Upon arrival, our local agent will transfer you from the airport to the hotel.

### **May 8 ~ Drive to Yanacocha, Old Nono-Mindo, and visit Cock-of-the-rock lek**

Travel from the high Andes to the cloud forest and observe the change in climate, vegetation, and geology while on the mainland. You'll visit Yanacocha Reserve and drive through Old Nono-Mindo Ecoroute for vibrant bird life. Spend your time observing the Andean cock-of-the-rock lek for colorful displays by the males plus many other special bird species in this area. Experience nocturnal mammals close to your lodge.

### **May 9 ~ Bird watching, including Refugio Paz de las Aves**

Spend the morning bird watching a variety of dazzling, colorful birds. Visit Refugio Paz de las Aves for more bird watching and a traditional Ecuadorian brunch. Take in the wildlife around the lodge at Bellavista, including countless colorful hummingbirds that frequent feeders on the lodge grounds. On your return to Quito, if time allows, visit Mitad del Mundo.

### **May 10 ~ Fly to Galápagos and land on Mosquera Islet**

After an early breakfast, transfer to the airport for your flight to the Galápagos Islands. Upon arrival in the islands, you'll transfer to the dock where the *Samba*, your home for this glorious adventure, awaits.

*All routings and visitor sites on the Galápagos Islands are subject to change by the Galápagos National Park Service in an attempt to minimize traffic and impact.*

After introductions and a safety briefing, you'll make your first landing at nearby Mosquera Islet where the beach rises from the ocean floor with sand grains as soft as sugar. This volcanic uplift, dating back 100,000 years, is home to Galápagos sea lions, sally lightfoot crabs, and shorebirds. Once back on board, relax with a welcome cocktail and meet the *Samba's* friendly, professional crew. In the evening, you will travel to Genovesa in the outer archipelago. As the moonlight beams on the dark waters, look for phosphorescence from ctenophores (comb jellies) and other plankton on the surface. If you are lucky, you may see them appearing to encapsulate dolphins in a glowing shield as they bow-ride with the boat.

### **May 11 ~ Isla Genovesa: Darwin Bay and Prince Philip's Steps**

Anchor in the huge flooded volcanic caldera that created Darwin Bay. As you approach, observe the walls of the caldera, which provide wonderful ledges for the very rare Galápagos fur seals and nesting sites of red-billed tropicbirds. You will hike up a stony stairway known as Prince Philip's Steps for great views of red-footed and Nazca booby colonies on the way to the wedge-rumped (Galápagos) storm-petrel colony. The island's largest red-footed booby nesting site is located here too. Keep an eye out for the elusive short-eared owl that hunts for storm-petrels during the day.

After your first snorkeling of the trip, you'll end your day with excellent views of red-footed boobies and great frigatebirds nesting with unparalleled density. Following the cliff edge, photograph and observe incoming boobies and frigatebirds. Frigatebirds are ceaseless with aerial displays of kleptoparasitism as they "dog-fight" along the cliffs for scarce nesting material. Genovesa's four species of Darwin's finches – common cactus-finch, green warbler-finch, gray warbler-finch, and large ground-finch – show huge variation in bill size, and you can find all four species here (one of the most outstanding sites that you will visit for Darwin's finches along with the Highlands of Santa Cruz). Unlike trips with shorter itineraries, you'll have the luxury of anchoring in the calm waters of Darwin Bay for the night.

### **May 12 ~ Isla Marchena: Punta Mejía and Playa Negra**

You will have the rare opportunity to visit Marchena, making your experience truly unique. Although landings are not permitted, it is one of the best places to snorkel with tropical fish, rays, sea turtles, sharks, and eels. You may also find hermatypic (reef building) coral formations here, an uncommon sight in the rest of the archipelago. During your navigation to and from Marchena, you sail through some of the most whale-rich waters in the region, so keep your eyes on the horizon and your binoculars ready!

### **May 13 ~ Isla Isabela: Punta Albermarle and Punta Vicente Roca**

Punta Albermarle is not commonly visited, but home to one of the loveliest flightless cormorant colonies in the Galápagos. This landing is your first endeavor on Isabela, by far the largest in the archipelago.

The northwest tip of Isabela, called Punta Vicente Roca, sits at the edge of a sharp drop into deep, nutrient-rich waters. You may see Galápagos penguins, brown noddies, sea turtles, marine iguanas, blue-footed and Nazca boobies, marine mammals, and the bizarre-looking sunfish (*Mola mola*).

En route to Fernandina, keep your eyes out for whales in the cold, deep water on the western side of the archipelago. These waters offer the chance to see orcas, pilot whales, and larger species such as sperm whales. A study by Hal Whitehead, with the help of World Wildlife Fund, found sperm whales particularly abundant west of Isabela where the subsurface Cromwell Current meets land and provides oxygen- and nutrient-rich upwellings that supports a high density of squid that they feed on.

#### **May 14 ~ Isla Fernandina then back to Isla Isabela**

Across the calm Canal Bolivar, separating Isabela from Fernandina, sits Punta Espinoza, one of the most wildlife-rich sites of the trip. Fernandina, the youngest of the Galápagos Islands, is one of the world's most pristine islands because no known introduced animals have become established here. You'll have the unique opportunity to observe and photograph marine iguanas sunbathing in piles by the hundreds. The famous flightless cormorant also inhabits this island along with Galápagos penguins, lava lizards, and pelicans. Take a walk along the relatively young basalt (lava rock) to find lava cactus (*Brachycereus nesioticus*), the only species in its genus, growing directly out of what still seems like fresh lava. To protect the algae-covered coastline that marine iguanas depend on for food, snorkeling is no longer allowed.

This afternoon, you head back to Isabela for a very interesting landing at Urbina Bay. In 1954, this portion of Isabela lifted out of the sea so suddenly that fish and a sea turtle were literally trapped high and dry on a freshly changed coastline. You will explore this unusual site to examine evidence of the geologic forces that continue to shape these islands. Along your walk, you will find rocks full of bleached shells and massive coral heads now far from the sea. Large iguanas, both land and marine, live here as well as a few giant tortoises, the species for which the Galápagos Islands were named. You will snorkel in some of the coldest water of the trip but, thankfully, your full-length wetsuit will insulate as you discover the underwater world.

#### **May 15 ~ Isla Isabela: Elizabeth Bay and Punta Moreno**

Your morning begins with a visit to Elizabeth Bay, one of the most spectacular locations for panga (small boat) cruising. You cruise with the swimming sea turtles in this paradise, following channels through the verdant green mangrove forests. The endemic flightless cormorant and the Galápagos penguin are in their prime habitat in these cold, rich waters. Then you travel to the wildly stark landing site of Punta Moreno (Dark Point) where raw basalt coats the landscape and rises into the slopes of the shield volcanoes of Sierra Negra and Cerro Azul. Yet amid the stark, seemingly sterile landscape, you'll discover rich lagoons full of life. This evening, you'll travel through more nutrient-rich waters excellent for whale watching.

#### **May 16 ~ Isla Floreana: Asilo de la Paz, Cerro Alieri, and Devil's Crown**

After breakfast, land at Puerto Velasco Ibarra and ride up to the highlands in a chiva (a small open-sided bus). Depending on the town's COVID restrictions, you may stop to climb Cerro Alieri where many steps will reward you with a breathtaking view and the chance to see the famous medium tree-finch. If you are not able to stop at Cerro Alieri, you will have the chance to visit Baroness Lookout. The fantastic landscape of the highlands is decorated with lichens and epiphytes. Floreana also holds compelling human history that includes pirate caves, European settlers, the islands' first citizen birth, and unexplained disappearances. Share a wonderful lunch in the highlands with Claudio Cruz and his family, providers of many of the organic foods that you've enjoyed on board. You'll also have the opportunity to photograph a group of giant tortoises that are kept in a large enclosure. After returning to the *Samba*, you will sail to one of the best spots in the world for snorkeling – Devil's Crown. You normally see rays, sea turtles, surgeonfish, parrotfish, jacks,

wrasses and many other tropical fish. This afternoon, you'll navigate to Santa Cruz Island for a quiet dinner in Academy Bay.

### **May 17 ~ Isla Santa Cruz: Highlands and Charles Darwin Research Station**

Upon reaching Santa Cruz, you'll anchor in Academy Bay beside the bustling small town of Puerto Ayora, the islands' primary population center. You'll travel to the Santa Cruz highlands to seek out elusive island endemics in beautifully unique habitats. You will explore Los Gemelos, two incredible volcanic sinkholes surrounded by *Scalesia* forest. The elegantly tall *Scalesia* trees evolved from beach composites, making it essentially the world's largest daisy. In the highlands you may see the shy Galápagos rail, short-eared owl, large and small tree-finches, vegetarian finch, and the famous tool-using woodpecker finch. You will also walk through a lava tube left over from Santa Cruz's active volcanic island-building days.

You return to Puerto Ayora in the afternoon to visit the Charles Darwin Research Station, the center of evolutionary science and conservation in the Galápagos. Your visit includes the opportunity to see the resident tortoises and enjoy an intimate look at the captive breeding programs whose goal is to return the Galápagos to a more pristine, pre-colonization state. This is one of your best opportunities to photograph tortoises up close.

### **May 18 ~ Isla Floreana: Punta Cormorant and Post Office Bay**

You will land behind Punta Cormorant for a walk to the flamingo lagoon in search of shorebirds and a few flamingoes. The plant life here is unique and includes another species of the endemic composite *Scalesia*. The waters around Floreana are great for dolphins so keep your eyes open! These waters are also rich with seabirds, such as waved albatross, three species of storm-petrels, Galápagos shearwaters, and large flocks of diving boobies. After lunch you'll stop briefly at Post Office Bay, where you can continue the whalers' tradition of dropping a letter or postcard in the box and taking one to hand deliver to someone else.

### **May 19 ~ Isla Española: Punta Suárez with waved albatross and Gardner Bay**

Punta Suárez is unique beyond description and as rich as any spot in the Galápagos Islands. You'll find huge numbers of breeding birds and iguanas, and most significantly, the majority of the world's waved albatross nest here. Young adults and birds that recently pair will court each other, a most enticing expression of the lifelong bond that breeding and survival depend upon – an unforgettable site to observe! You will also find the fearless Española mockingbird, blue-footed and Nazca boobies, swallow-tailed gull, Galápagos hawk, marine iguana, lava lizard, and Galápagos sea lion. The seascapes are spectacular, particularly where the waves force water through a blowhole spouting up to 75ft high.

This afternoon, you'll sail to Gardner Bay, one of the most beautiful beaches in the Galápagos. A nearby snorkel is likely to find you in the water with playful sea lions. Galápagos sea lions populate the surf while the remarkably brave Española mockingbird may peck your water bottle for water. Enjoy photographing shorebirds and sea lions, looking for the large cactus-finch, or walking along the beautiful beach.

### **May 20 ~ Isla San Cristóbal: Punta Pitt and Isla Lobos**

One of the oldest islands is home to Puerto Baquerizo Moreno, the capital and second largest population in the Galápagos Province. In the morning you'll have an opportunity to stretch your legs at the geologically striking Punta Pitt and examine some of the island's vegetation, which includes endemic flowering plants such as *Calandrinia galapagosa* (a plant that resembles a small baobab and is in the Miner's Lettuce family) and *Lecocarpus darwinii* (a plant in the Sunflower family). Then travel along the north coast for some excellent wildlife and snorkeling at Isla Lobos. Look for frigatebirds, sea lions, sea turtles, blue- and red-footed boobies, tropicbirds, marine iguanas, swallow-tailed gulls, and dolphins.

### **May 21 ~ Isla Santa Fé: Barrington Bay, Isla Plaza Sur**

This morning, you'll land on Santa Fé Island. The short hike from the beach to a low plateau rewards you with great views and *Scalesia* that thrives near a large forest of the amazing giant prickly pear cactus (*Opuntia* spp.). Search the cacti for Santa Fé land iguanas, which are a separate species from the others in the Galápagos and can grow up to 5ft in length!

The small yet incredible island of South Plaza is your afternoon destination. This beautiful island is home to many land and marine iguanas. The colorful landscape is covered with reds and greens of *Portulaca* that may have yellow flowers that the iguanas enjoy eating. In the giant prickly pear cactus you can compare the common cactus-finch alongside small and medium ground-finches. At the top of the island bachelor sea lions escape from the competition of stronger males as red-billed tropicbirds fly gracefully by.

### **May 22 ~ Sombrero Chino Islet and Isla Bartolomé: Pinnacle Rock**

If the light is good in the early morning, you'll visit the surreal landscape of Sombrero Chino (Chinese Hat), a symmetrical cinder cone. Lava tubes run like petrified rivers and white sand from eroded coral surrounds the black rock. This afternoon, land at Bartolomé and climb to the 360ft-high summit for a gorgeous, iconic view of Pinnacle Rock and the surrounding bays. Then land on the beach for a short walk through mangroves and dune vegetation. Galápagos penguins are often present in small numbers near Pinnacle Rock so you will have a decent chance to snorkel with or near the penguins, and maybe even whitetip reef sharks (harmless but exciting)! Also enjoy colorful starfish, tropical fish, and amazing underwater lava formations.

### **May 23 ~ Isla Santiago: James Bay and Isla Rábida**

This morning you'll land at James Bay on the western side of Santiago. During low tide, explore the tidal pools that lead you to Fur Seal Grotto, where you are likely to find Galápagos fur seals swimming in emerald pools of the collapsed lava tubes.

In the afternoon you'll head to the islet of Rábida, with deep ochre red beaches creating a striking landscape. Sea lions playing in the surf make for splendid photo subjects against the red sand in the late afternoon light. Tonight, you head back east to North Seymour, just off the northern tip of Baltra. Sadly, this will be your final evening aboard the *Samba*.

### **May 24 ~ Isla Seymour Norte, disembark, fly to Quito**

You'll enjoy the last landing site teeming with wildlife and wander past many breeding blue-footed boobies and a large colony of magnificent frigatebirds. Hopefully you'll find males of both species in full display, the boobies sky-pointing and showing off their bright blue feet as they dance and the frigates calling for females with their wings spread wide and their dramatic red throat pouches inflated – an unforgettable sight! You also have the chance to see Galápagos sea lions, marine iguanas, striated herons, brown noddies, swallow-tailed gulls, and lava gulls. The endemic palo santo and low, bushy prickly pear cacti add great scenery to the amazing abundance of Galápagos wildlife. You'll reluctantly depart for Baltra and bid farewell to the *Samba* and its crew.

### **May 25 ~ Fly home**

## COSTS (ALL COSTS ARE IN US DOLLARS)

---

### Costs and Cabin Options

Type	Description (see <i>Deck Plan</i> on page 12)	Cost per Person
Lower Deck	Double occupancy, twin-sized upper and lower beds, private bath, and drawers for storage.	\$11,200
Upper Deck	Double occupancy, double bed, private bath, windows that open, closet, and drawers for storage.	\$12,300

Costs are per person depending on cabin type, double occupancy, not including airfare, singles extra. See *Included* and *Not Included* sections for more details.

If you are a single traveler, we will find a roommate for you, but if we cannot find you a roommate, we will not charge you a single supplement. If space is available, some cabins can be booked as a single by adding **90%** over the listed cabin cost.

We cannot guarantee a specific cabin number, but if changes occur, we will assign a cabin of equal or greater value.

### Payment Schedule

Payment	Due Date	Amount per Person
Deposit	Due now to reserve your space	\$500
Second	June 15, 2021	\$4,000
Final	December 1, 2021	Remaining Balance

Payments are due based on the schedule above. All reservations require a deposit to confirm reservation of your space.

### Cancellations

Refunds are given depending on the time left before departure according to the following table. The cancellation fee of \$300 per person can be applied toward another trip if reserved within six months of the cancelled trip's departure date. Cancellations are non-transferrable. Consider purchasing trip cancellation insurance that could reimburse your trip costs in the event of your cancellation.

Dates	Forfeited Amount per Person
On or before September 30, 2021	\$300
October 1 to October 31, 2021	10% of trip cost
November 1 to November 30, 2021	40% of trip cost
On or after December 1, 2021	100% of trip cost

### Included

- All leaders, transport, landing fees, and permits for all activities unless described as optional.
- Fourteen nights aboard the *Samba*.



- Accommodations on mainland Ecuador for the nights of May 7 through May 9 and May 24.
- Meals from breakfast on May 8 through breakfast on May 25, except meals listed in *Not Included* section.
- The Holiday Inn Quito Airport has a complimentary hotel airport shuttle to and from the Quito Airport.
- Snorkel gear and full-length wetsuit on the *Samba*.
- The Galápagos National Park Entrance Fee (\$100) and Transit Control Card (\$20).
- The Government of Ecuador fuel tax/surcharge that applies to most Galápagos vessels does not apply to the *Samba* because it is a smaller, locally-based, fuel-efficient vessel, using less than 3,000 gallons of diesel per month.
- Trip Materials – information about flights, packing, entry and departure requirements, airport transfers, gratuities, etc.

### Not Included

- All airfare, airport and departure taxes, and excess baggage fees. Round-trip airfare is approximately \$600 to \$1,100 between the US and Quito, plus approximately \$550 for round-trip flights between Quito and Baltra.
- Lunch and Dinner on May 24.
- We can arrange extra hotel nights for an extra cost.
- Gratuities – tipping is always discretionary. However, we suggest budgeting about \$650 to \$780 total per participant.
- Mandatory emergency medical and evacuation insurance. For more information see [www.cheesemans.com/travel-insurance](http://www.cheesemans.com/travel-insurance).
- Optional trip cancellation insurance. For more information see [www.cheesemans.com/travel-insurance](http://www.cheesemans.com/travel-insurance).
- Items of a personal nature such as laundry, telephone calls, medical costs or hospitalization, room service, alcoholic and other beverages, items not on the regular menu, etc. If you have special dietary needs, please indicate them on your Reservation Form.

## SIGN UP

---

Please contact us first to check availability, reserve your space, and obtain a Reservation Form. To confirm your reservation, we require a deposit and signed form from each participant.

Cheesemans' Ecology Safaris  
 Email: [info@cheesemans.com](mailto:info@cheesemans.com)  
 Website: [www.cheesemans.com](http://www.cheesemans.com)  
 WhatsApp: (408) 741-5330 | Skype: CheesemansEcologySafaris  
 Phone: (800) 527-5330 or (408) 741-5330

## OTHER DETAILS

---

### Climate

Average temperatures range from the low to mid-60s°F (15 to 18°C) at night up to the 80s°F (26 to 31°C) during the day. The water temperature averages 70 to 74°F (21 to 23°C). Average temperatures during your

mainland excursion range from nighttime lows in the 50s°F (10 to 15°C) to mid 60s°F (18°C) to daytime highs from mid 60s°F (18°C) to low 80s°F (26°C).

### **Fitness Level**

Walks on shore vary from short strolls on the beach to a few miles over uneven terrain. If you are not accustomed to walking long distances, you will still enjoy most activities as your pace allows you to see, appreciate, and photograph the unique nature of the Galápagos. If you anticipate struggling with the walks, do some hiking beforehand to get in good shape. You must be comfortable going up and down stairs on board and getting in and out of the panga (small boat).

Although snorkeling is not mandatory, it is a significant part of the voyage as you are in the water every day, sometimes twice a day. Even though you do not have to have snorkeling experience, proficient swimming abilities will allow you to fully enjoy this activity. Most snorkeling will be panga-based, sometimes over deep water, which is not an ideal place to learn to snorkel, especially if you are uncomfortable or intimidated by these conditions. It's beneficial to get some experience in advance, however, the *Samba* crew will always assist you. Please contact us if you have any health concerns that may make this trip challenging.

### **Seasickness**

Don't let a fear of seasickness keep you away! For all but the most sensitive, seasickness is rarely a problem in the Galápagos. Because you are close to the islands most of the time, the seas tend to be gentle and the few open-ocean passages will be overnight. It's a good idea to bring medication if you get seasick or are unsure, but you may find that you do not need it after a couple days once you have your "sea legs." Even those who have experienced seasickness reported that the charm and beauty of the islands and their incredible wildlife were well worth the temporary discomfort. Read our suggestions for coping with seasickness at [www.cheesemans.com/seasickness](http://www.cheesemans.com/seasickness) and contact us if you have any concerns.

### **Flights**

Airfare is not included in trip costs. Detailed logistical information and the contact information for our recommended flight-ticketing agent are included in the Trip Materials we will send you. Please let us know if you are arriving earlier or staying later as we are happy to assist you with any extra overnights that you might want to arrange.

Flights you (or a travel agent) book: Arrive in Quito, Ecuador (UIO) by 4:00pm on May 7. Depart from Quito, Ecuador (UIO) anytime on May 25.

Flights we book for you: The round-trip flights between Quito and Baltra; we'll add the flight cost to your final trip balance.

### **Terms and Conditions**

Read our current Terms and Conditions at <https://cheesemans.com/terms-and-conditions>.

### **Conservation**

Cheesemans' Ecology Safaris is passionate about conserving the precious regions that we travel to and supports many conservation efforts. By visiting these areas, we contribute to sustainable conservation of these valuable wildlife habitats. We urge you to support conservation organizations that protect and restore natural habitats and write letters to tourism and government agencies to promote work in preserving wildlife.

We aim to make all our trips carbon neutral by splitting the cost of carbon offsetting with our participants. For your convenience, the optional donation amount for your half of the carbon offset will be indicated on your invoice. We source high quality offsets through CarbonTree Conservation Fund, a non-profit we helped found, supporting pioneering forest conservation in the Rio Bravo Reserve in Belize, a Nature Conservancy project ([www.nature.org/en-us/about-us/where-we-work/latin-america/belize/rio-bravo-conservation-area/](http://www.nature.org/en-us/about-us/where-we-work/latin-america/belize/rio-bravo-conservation-area/)).

## FAQS

---

### **What species and behaviors can I expect to see in May and June?**

May and June are the best months to see breeding activity, especially bird courtship. Waved albatross perform their exquisite courtship dance, and some may already have eggs. Frigatebirds will court females by inflating their blood red throat sacs while clattering their bills, quivering their wings, and waving their heads back and forth; great frigatebirds courtship will wind down on Genovesa, while magnificent frigatebirds courtship will be active on North Seymour. Because the well-known blue-footed booby is an opportunistic breeder, it's very hard to predict whether you will see them courting, but we have reliably seen courtship in previous years during these months. You may even see a few chicks!

In June, as the garua (cool/dry) season becomes more prominent and the water temperatures cool, marine life becomes more plentiful. You may have a better chance to encounter more Galápagos penguins, whales, and dolphins feeding in the nutrient rich, cool waters.

### **What can I do if I don't want to snorkel?**

Year after year, many of our travelers comment that the beautiful underwater environment was their favorite part of the trip. We strongly encourage you to snorkel even if you are not a strong swimmer. The *Samba* crew will always assist you! If you elect not to snorkel, you can relax aboard the *Samba*.

## SAMBA DECK PLAN

---

TOP DECK



MAIN DECK

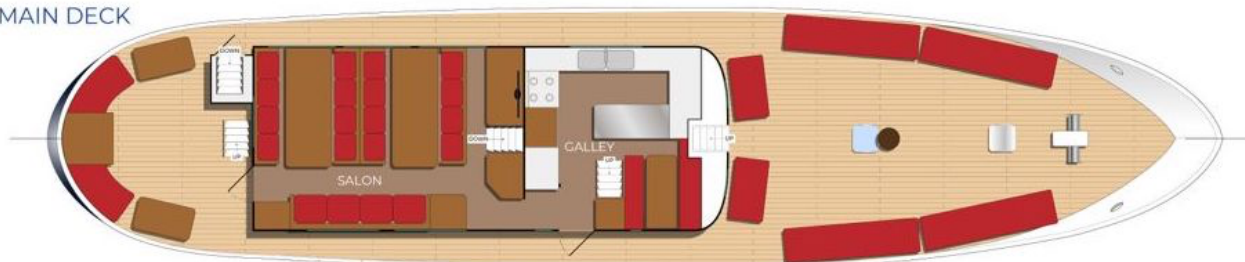

BOTTOM DECK



Deck plan and cabin sizes are not to scale and shows the number of beds, not actual bed arrangement.  
See cabin descriptions under the Costs section on page 8.